

JJ Blinds

Ph - 0470 662 221 | Email - info@jjblinds.com.au

Website - www.jjblinds.com.au

ALUMINIUM VENETIAN BLIND FITTING INSTRUCTIONS

Your new Aluminium Venetian Blind has been custom built for you from the highest quality materials please follow the installation instructions provided.

HARDWARE

Please note : Screws are not supplied for bracket fixings and are dependent on the surface to which you are fixing please see chart below for recommended guide :

FIXTURE GUIDE	RECOMENDED (Philips head)
Wood	¾" 8 gauge for recess fit and ½" 8 gauge for face fit
Steel	½" 6 gauge
Ceiling	Toggle Bolt
Plasterboard	Wall mates
Aluminium	½" 8 gauge or tech screw
Brick	Green plug & 1 ½ " 8 gauge self tapper

1. Depending on if your blind is face fit or recess fit place the brackets in position and with a pencil mark the surface of the wall or window recess for drilling. Brackets should be positioned at each end of the head rail avoiding internal controls. On larger blinds one or more central support brackets are required.

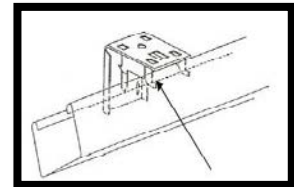

Brackets

2. When you are happy that you have correct positions for the brackets pre drill the screw holes and fix brackets securely.

3. To fix the blind in position, gently push the head rail onto the front hooks of the bracket (this is the plastic sprung insert) Push inwards and twist the back of the head rail upwards in one motion. The head rail will snap into position.

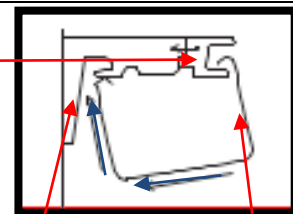

Bracket Head box

4. Secure the safety cleat supplied, firmly to the wall at least 1.6m up from the floor to avoid a choking hazard. It is important to keep chains and cords safely away from children your new blind will have a safety warning tag attached please read carefully and do not remove.

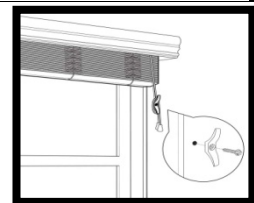

Safety cleat

5. To operate your new blind use cord control to lift and lower, using a steady tension and movement and avoid jerking or tugging of the cords.

6. Your blind is now installed and ready. We hope it brings you and your home many years of great functionality and beauty. We thank you for your purchase.

IMPORTANT INFORMATION

WARNING

ALL WINDOW COVERINGS WITH CORD OR CHAIN



Installation instructions

To avoid strangulation hazard, all internal window coverings with cord/ chain controls must have a child safety device installed where the cord has the possibility of forming a loop of 220mm or longer and it is at a height of less than 1600mm above floor level

To avoid creating a possible strangulation hazard for children , the corded internal window covering must be installed in such a way that the loose cord cannot form a loop of 220mm or longer at a height of less than 1600mm from floor level.

When using a cleat (Style 1) to secure the cord it must be at least 1600mm from floor level because a child is capable of unwinding a cord from a cleat. Please wind cord in a figure 8 dimension as indicated on Style 1 diagram.

A cord guide (Style2) may be installed lower than 1600mm above floor level if the cord is sufficiently secured or tensioned to prevent a loop 220mm or longer from being formed. If the cord is installed lower than 1600mm from floor level it must be designed to prevent a child from being able to remove the cord.

Making Blinds and Curtains Safer for Children

Blinds and curtain cords can be made safer in the following way:

Attach a Safety Device (enclosed)

Attach a cleat (Style 1) to the wall or window frame 1600mm or higher from the floor away from children or pets and wrap around the cleat.

- 1) Affix cleat with screws as shown
- 2) Wind loose cord around safety cleat

Attach a cord guide (Style 2)

- 1) Affix cord guide with screws as shown
- 2) Secure cord in cord guide at all times

Style 1 - Cleat

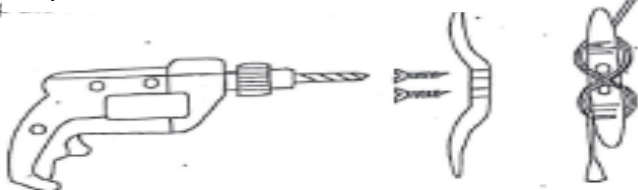

Style 2 - Cord guide

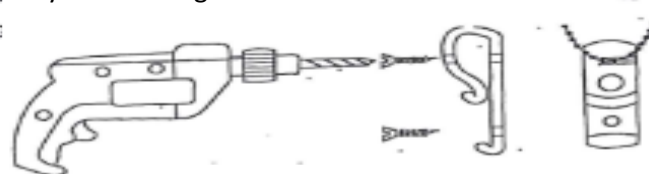

'WARNING: CURTAIN AND BLIND CORDS HAVE CAUSED THE DEATH OF YOUNG CHILDREN AND MUST BE INSTALLED SO THAT THEY ARE NOT A STRANGULATION HAZARD. FOLLOW THE INSTALLATION INSTRUCTIONS'.